

AMC-ANT-2J6726B

Iridium screw mount antenna

Features

- Iridium
 - 1616 – 1627MHz
- Screw mount
- Iridium certified
- Ground plane independent
- Customisable cable and connector
- Dimensions: \varnothing 77.3 x 36.5mm
- Certificates IP67, IP69K, IK09



1. Antenna and electrical specifications

Parameters	Iridium Antenna
Standards	Iridium
Band (MHz)	1621
Frequency (MHz)	1616 - 1627
Return Loss (dB)	~-18.8
VSWR	~1.2:1
Efficiency (%)	~76
Peak Gain (dBic)	~4.5
Average Gain (dB)	~-1.1
Impedance (Ohms)	50
Axial Ratio (dB)	3 Max
Radiation Pattern	Hemispherical
Polarisation	RHCP
Connector Type	SMA male standard (other connectors available)
Cable Length	300cm standard (other lengths available)
Cable Type	LMR100 standard (other cables available)

Measurement conditions:

- Free space
- 150cm LMR195 cable
- Measured in certified CTIA 3D anechoic chamber



2. Mechanical and environmental specifications

Mounting Type	Screw mount
Dimensions (mm)	Ø 77.3 x 36.5
Max. Tighten Torque (Nm)	6
Radome Type	ABS or ASA
Radome Colour	Black
Gasket	TPE
Antenna Base	Zamak
Operating Temperature (°C)	-40 to +85
Storage Temperature (°C)	-40 to +85
Certificates	Iridium certified, IP67, IP69K, IK09
Substance Compliance	RoHS



3. Antenna drawings

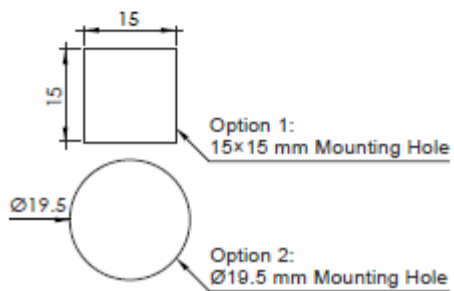
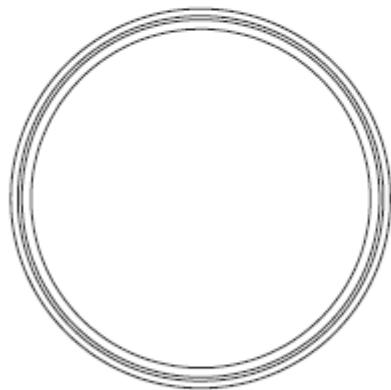
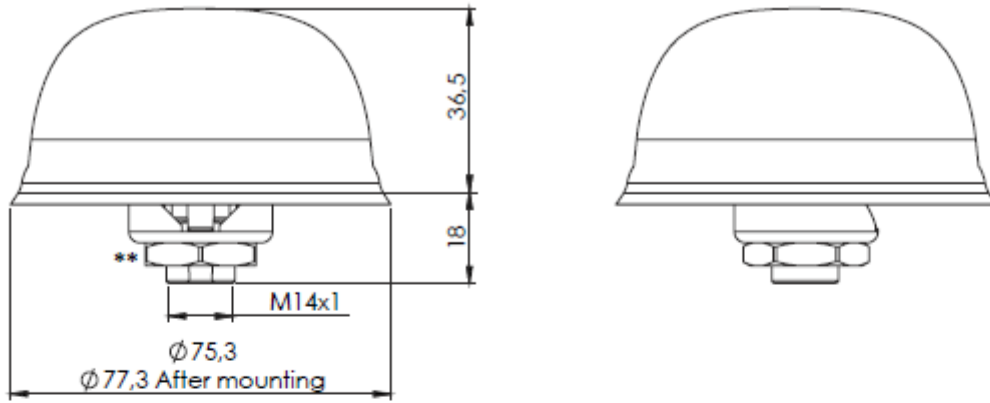

Note: Dimensions are in millimeters
*Dimensions are after mounting
**Max. Torque= 6 Nm



4. Antenna parameters

Cable 1: IRIDIUM

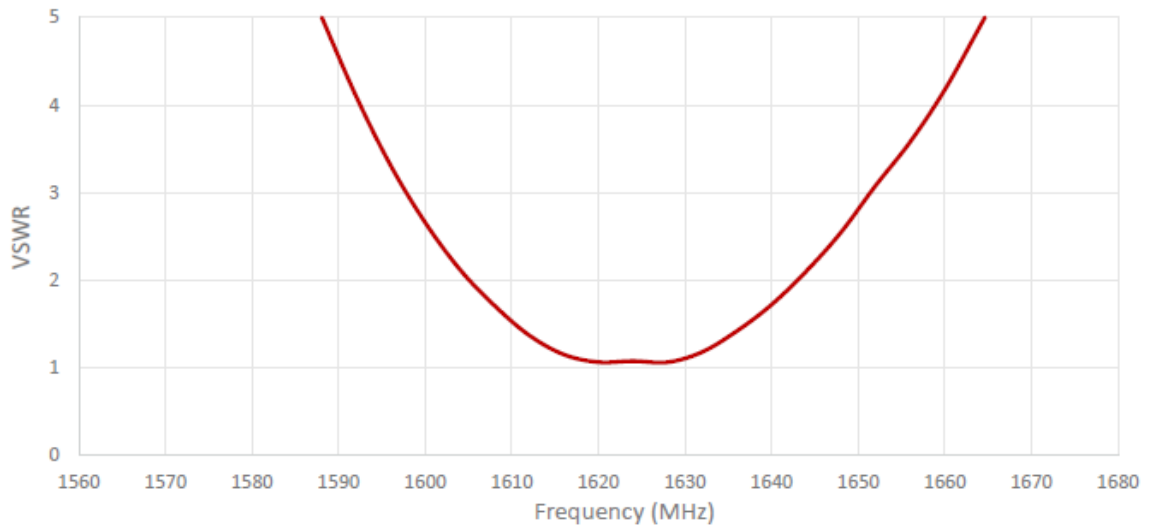
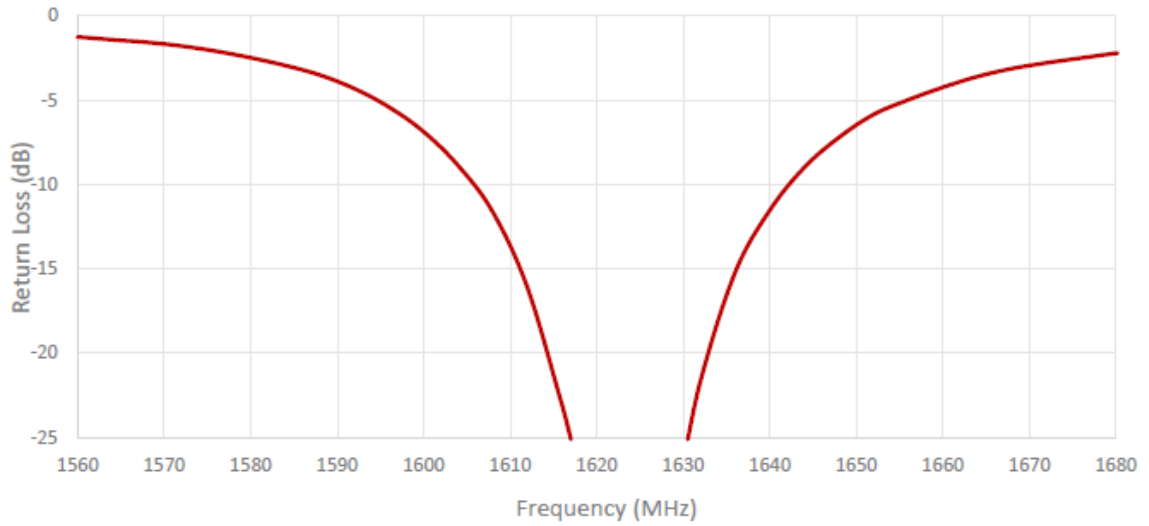

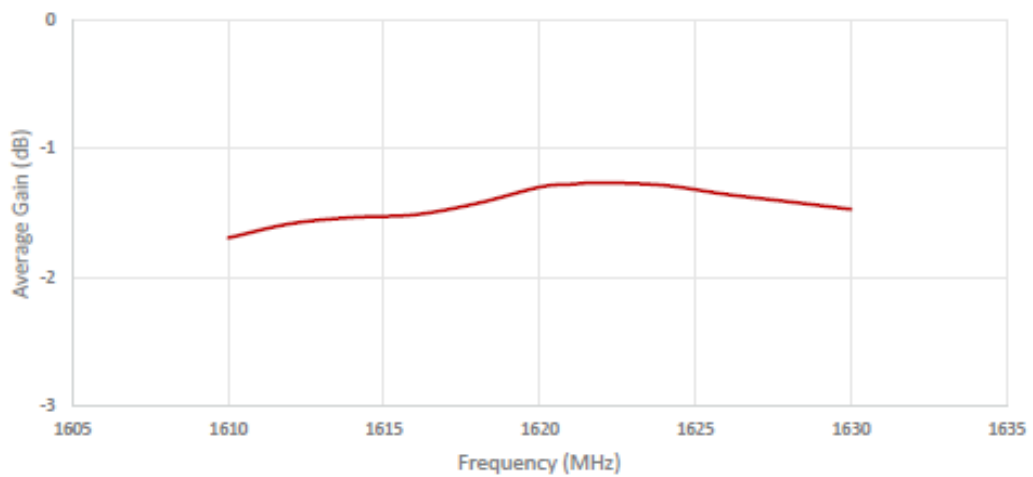
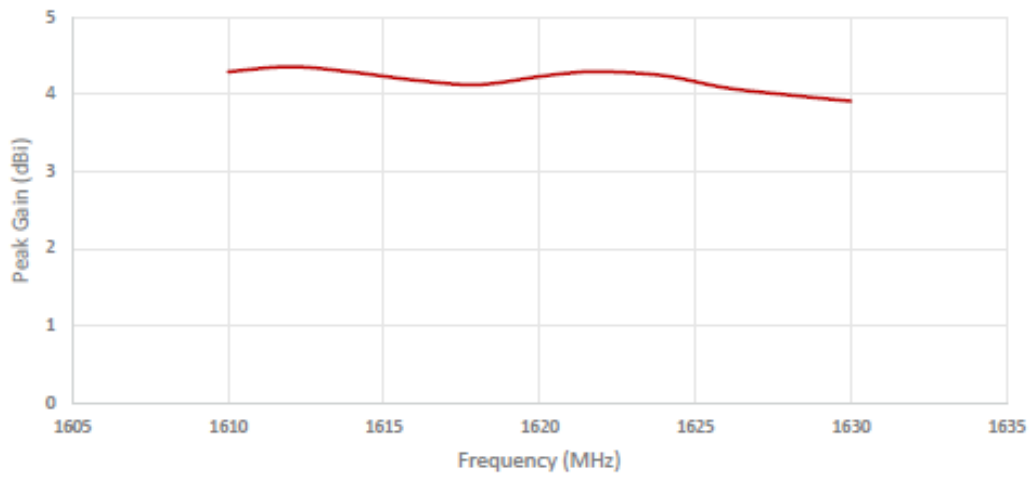
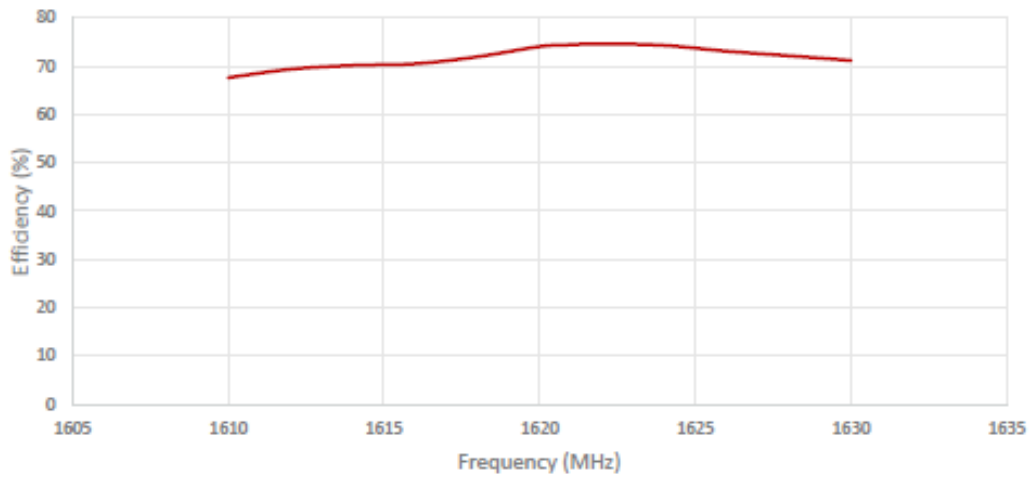

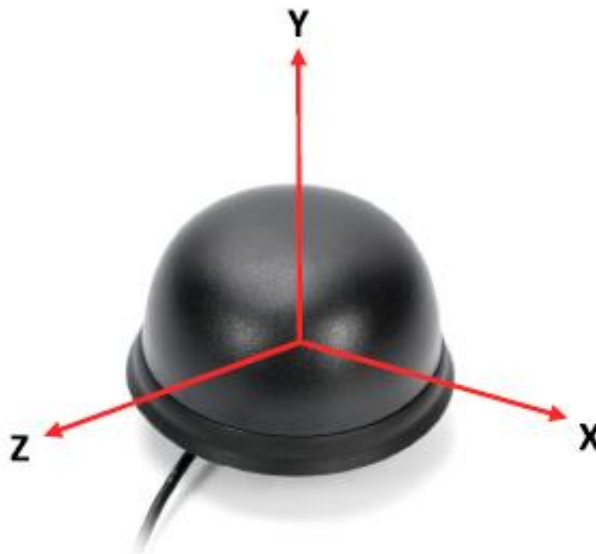

Radiation pattern reference

Cable 1: IRIDIUM

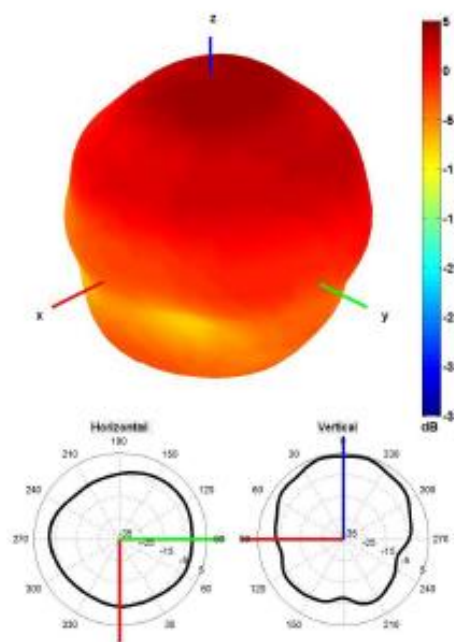

1621 MHz Radiation pattern

