

AMC-ANT-2JP0133BGF

GPS/GLONASS & Iridium screw mount embedded antenna

Features

- **Cable 1: GPS/GLONASS/QZSS/Galileo**
 - 1575 - 1606MHz
- **Cable 2: Iridium**
 - 1616 - 1627MHz
- Embedded antenna
- 28dB gain
- Pre-filter
- Low noise figure
- Low power consumption
- Ground plane independent
- Dimensions: 74 x 45 x 8.8mm

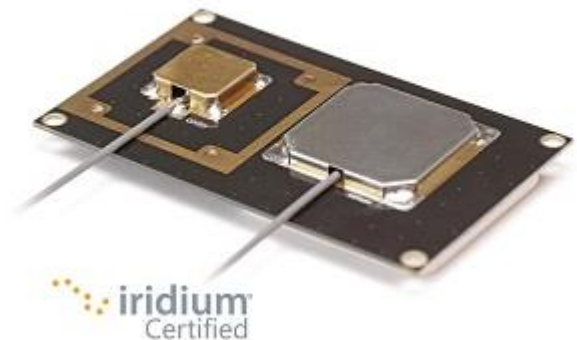

1. Antenna and electrical specifications

Cable 1

Parameters	GNSS ceramic active antenna	
Standards	GPS/QZSS/Galileo	GLONASS
Band (MHz)	1575	1602
Frequency (MHz)	1575.42	1598 - 1606
Passive Gain (dBi)	~-3.6	
Impedance (Ohms)	50	
Radiation Pattern	Hemispherical	
Voltage Range (V)	1.5 – 3.6	
Active Gain (dB)	28 @ 2.7V	
Noise Figure (dB)	1.8 @ 2.7V	
Current Consumption (mA)	9 @ 2.7V	
Power Consumption (mW)	24.3 @ 2.7V	
SAW Filter Type	Pre-filter	
Out of Band Rejection (dB)	~43	
ESD Protection (kV)	6	
Connector Type	U.FL standard (other connectors available)	
Cable Length	100mm standard (other lengths available)	
Cable Type	1.37mm mini coax standard (other cables available)	



Cable 2

Parameters	Iridium ceramic antenna
Standards	Iridium
Band (MHz)	1621
Frequency (MHz)	1616 - 1626
Return Loss (dB)	~-18.8
VSWR	~1.2:1
Efficiency (%)	~76
Peak Gain (dBiC)	~4.5
Average Gain (dB)	~-1.1
Axial Ratio (dB)	3 max.
Radiation Pattern	Hemispherical
Polarisation	RHCP
Connector Type	U.FL standard (other connectors available)
Cable Length	100mm standard (other lengths available)
Cable Type	1.37mm mini coax standard (other cables available)

Antenna measurement conditions:

- Mounted on ground plane of 74 x 45mm]
- Measured in certified CTIA 3D anechoic chamber



2. Mechanical and environmental specifications

Dimensions (mm)	74 x 45 x 8.8
Operating Temperature (°C)	-40 to +85
Storage Temperature (°C)	-40 to +85
Substance Compliance	RoHS

3. Antenna drawings

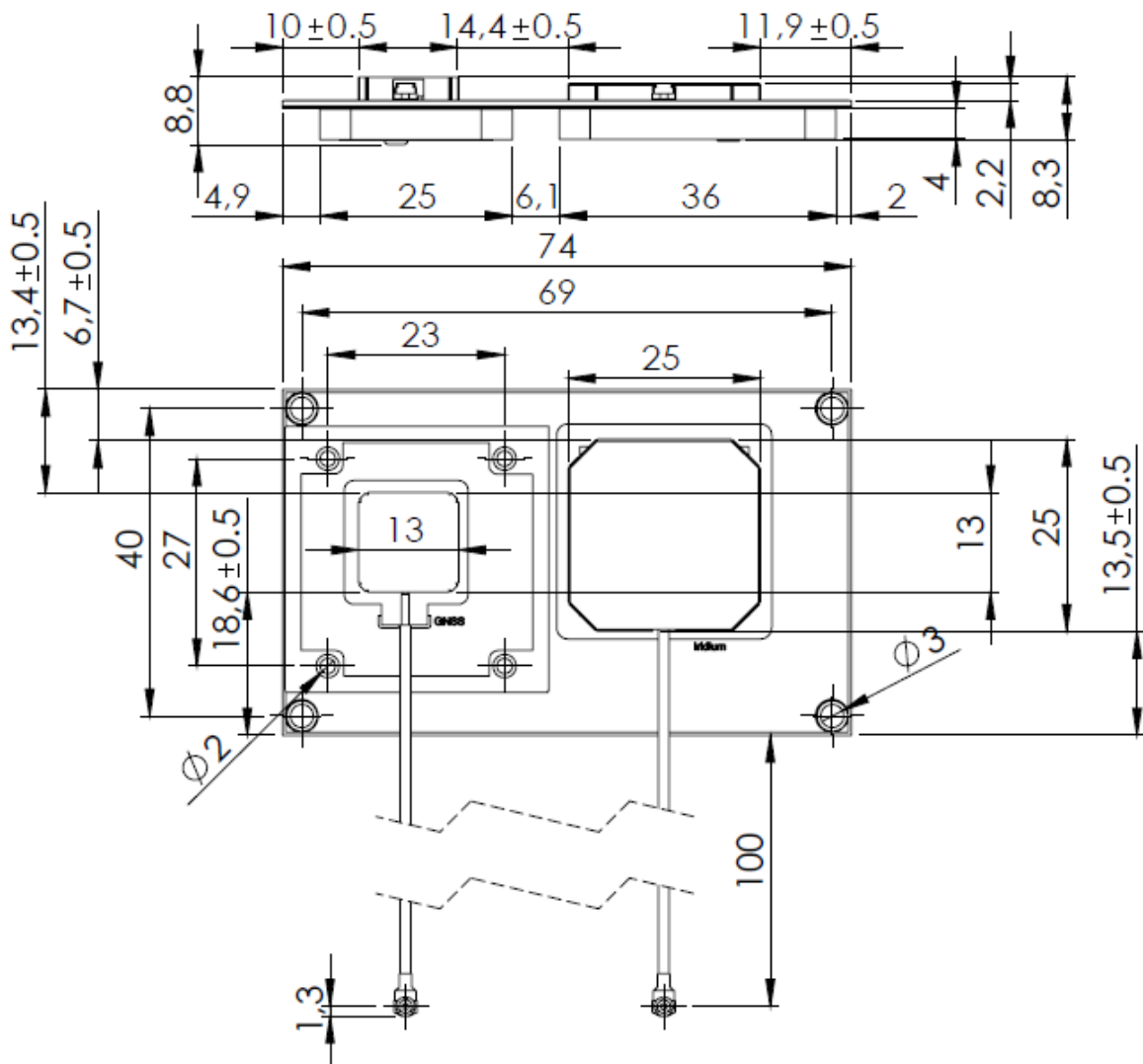

4. Antenna parameters

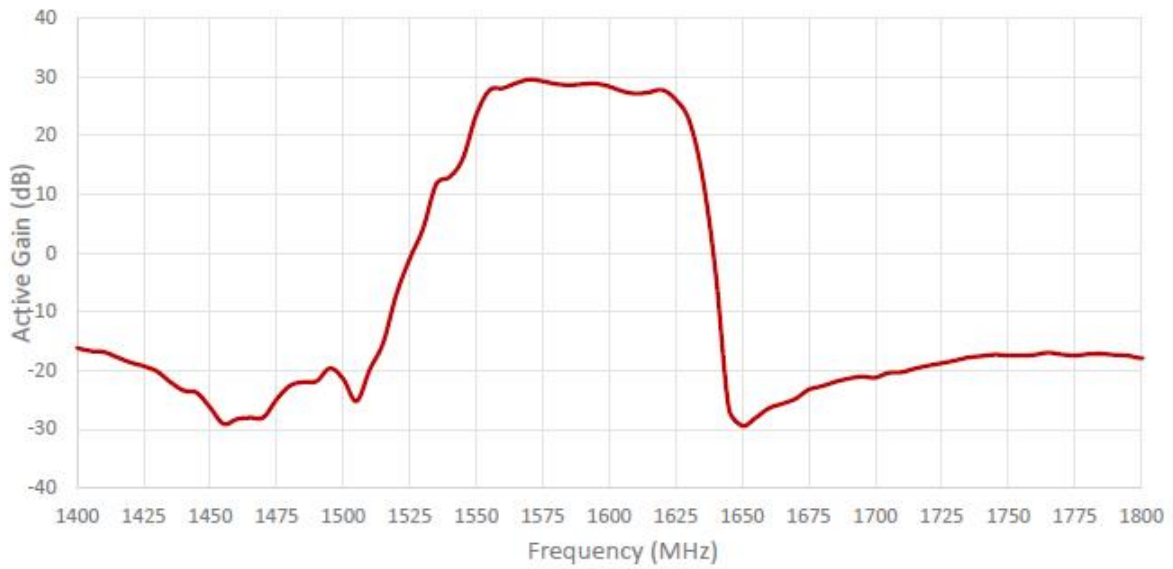

* Measured at 2.7 V

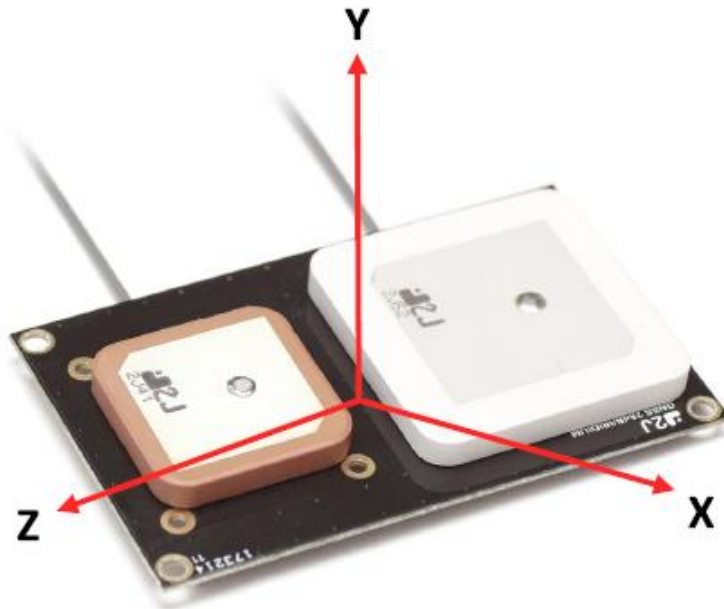

Radiation pattern reference



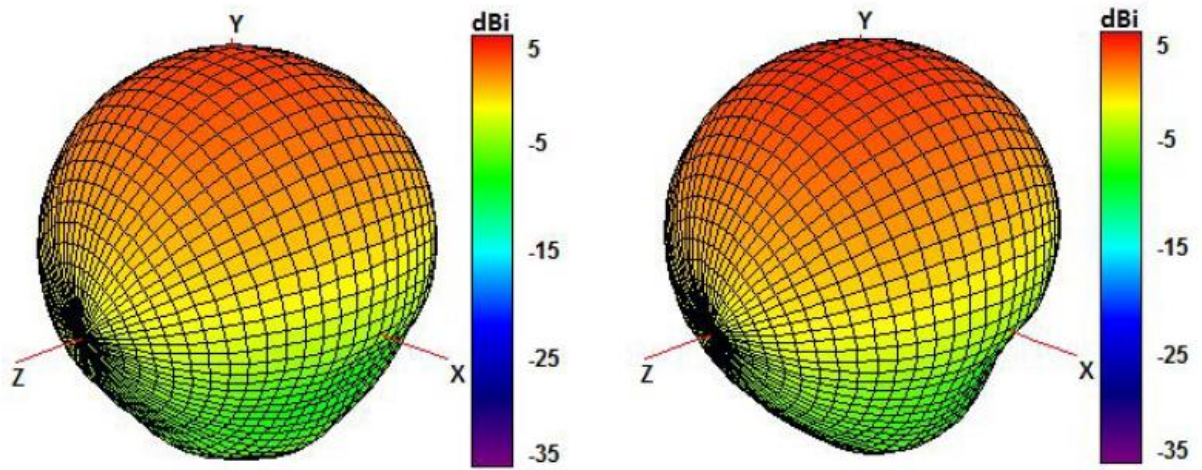

1575 and 1602 MHz Radiation pattern

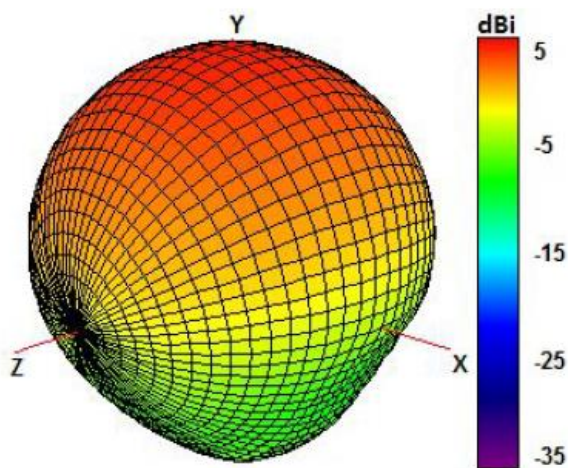

1621 MHz Radiation pattern

