

AMC-ICA-567-1-6PA-R



6-pin hinged 2FF SIM card connector, no mounting posts, with card detection

TECHNICAL CHARACTERISTICS

General Characteristics

- Dimensions(mm): 29.65(L) x 17.20(W) x 2.00(H)
- Weight: Approx. 0.75g
- Contact principle: Friction technology
- Operating position: Shaft up/down/horizontal
- Mounting system: SMT type (no posts)
- Durability: 10,000 cycles min.

Mechanical Characteristics

- Insulation material: Thermoplastic, UL 94V-0
- RoHS Directive: 2011/65/EU compliant

Electrical Characteristics

- Number of contacts: 6 pins
- Contact resistance: 50mΩ typical, 100mΩ max.
- Insulation resistance: >1000MΩ / 500VDC
- Switch type: Blade
- Operation: Normally open

Solderability

- Wave: Not applicable
- IR reflow: 260°C, 10 sec. max.
- Manual soldering: 360°C, 3 sec. max.

Environmental Characteristics

- Operating temperature: -40°C to +85°C
- Storage temperature: -40°C to +85°C
- Operating humidity: 10% to 95% RH
- Storage humidity: 10% to 95% RH

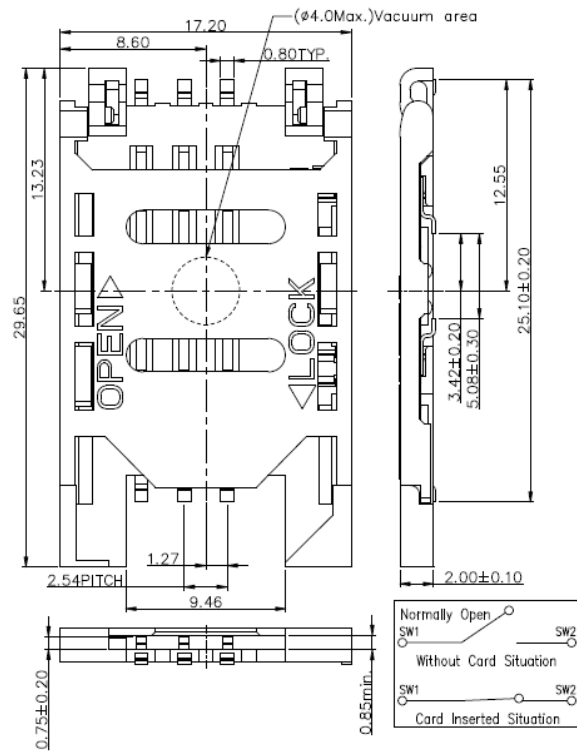

Unit: mm; Tolerances: ±0.15 mm
Mechanical outline dimension

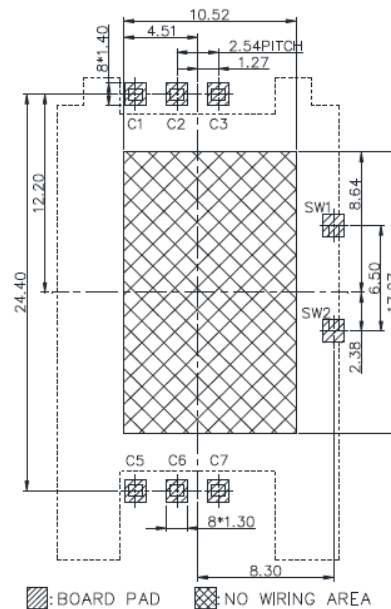

Unit: mm; Tolerances: ±0.05 mm
Reference dimension for PCB layout

Note:

1. Coplanarity of solder pins 0.10mm max.
2. Recommended thickness of solder paste > 0.15mm.